

Схема лесного участка

Местоположение лесного участка:

Лесничество Промышленновское, участковое лесничество Промышленновское,

Урочище Промышленновское, номер квартала 50, номера выделов 3

площадь участка 8,9 га

Масштаб 1:10 000

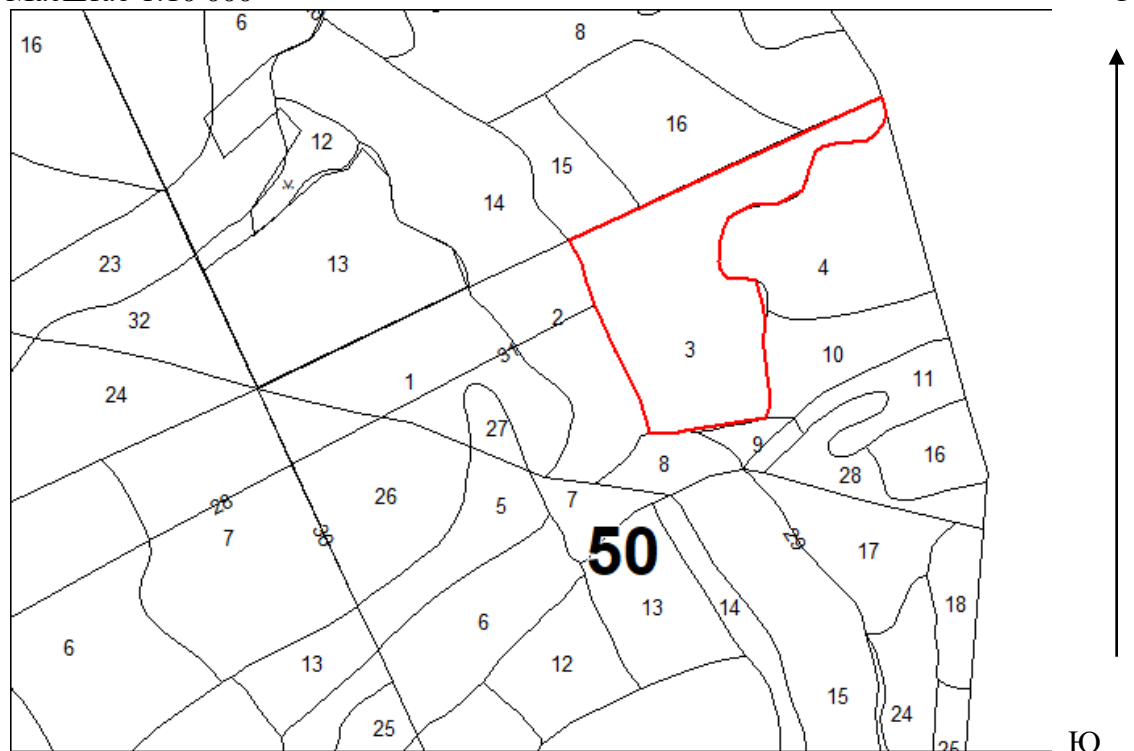

Условные обозначения

- граница лесного участка

| № п/п | Номера точек | Румбы линий (по истинному меридиану) | Длина, м | Система координат WGS-84, град | |
|-------|--------------|---|-------------|-----------------------------------|-------------|
| | | | | В(широта) | Л(долгота) |
| 1 | 1-2 | ЮВ:15°46'5.95" | 27,26 | 55,05065067 | 86,08740708 |
| 2 | 2-3 | ЮЗ:19°5'12.12" | 13,32 | 55,0504144 | 86,08751933 |
| 3 | 3-4 | ЮЗ:40°17'14.75" | 23,41 | 55,05030165 | 86,08744935 |
| 4 | 4-5 | ЮЗ:56°38'23.7" | 12,01 | 55,05014252 | 86,08721006 |
| 5 | 5-6 | ЮЗ:80°43'14.53" | 22 | 55,05008392 | 86,08705224 |
| 6 | 6-7 | ЮЗ:78°38'21.08" | 14,75 | 55,0500537 | 86,08671204 |
| 7 | 7-8 | ЮЗ:87°19'41.79" | 11 | 55,05002846 | 86,08648545 |
| 8 | 8-9 | ЮЗ:85°18'50.69" | 10,52 | 55,05002537 | 86,08631346 |
| 9 | 9-10 | ЮЗ:70°39'50.6" | 10,08 | 55,05001875 | 86,0861493 |
| 10 | 10-11 | ЮЗ:53°37'30.68" | 13,35 | 55,04998959 | 86,08599998 |
| 11 | 11-12 | ЮЗ:17°54'6.23" | 13,66 | 55,0499194 | 86,08583082 |
| 12 | 12-13 | ЮЗ:17°21'58.42" | 14,04 | 55,04980299 | 86,08576326 |
| 13 | 13-14 | ЮЗ:15°57'38.11" | 31,71 | 55,04968289 | 86,08569591 |
| 14 | 14-15 | ЮЗ:61°48'10.15" | 41,54 | 55,04940976 | 86,08555525 |

| | | | | | |
|----|-------|------------------|--------|-------------|-------------|
| 15 | 15-16 | IO3:86°39'43.79" | 39,92 | 55,04923643 | 86,0849798 |
| 16 | 16-17 | IO3:63°3'23.78" | 27,28 | 55,04921943 | 86,084356 |
| 17 | 17-18 | IO3:55°0'46.83" | 13,15 | 55,04911044 | 86,08397372 |
| 18 | 18-19 | IO3:28°45'8.1" | 18,59 | 55,04904357 | 86,08380423 |
| 19 | 19-20 | IO3:14°51'57.98" | 17,62 | 55,04889793 | 86,0836621 |
| 20 | 20-21 | IO3:1°53'58.96" | 19,41 | 55,04874535 | 86,08358891 |
| 21 | 21-22 | IO3:8°26'53.37" | 11,96 | 55,04857112 | 86,08357624 |
| 22 | 22-23 | IOB:16°52'15.46" | 12,99 | 55,04846497 | 86,08354705 |
| 23 | 23-24 | IOB:37°21'21.53" | 10,89 | 55,048353 | 86,08360433 |
| 24 | 24-25 | IOB:52°19'43.49" | 9,88 | 55,0482747 | 86,08370653 |
| 25 | 25-26 | IOB:88°28'48.47" | 13,22 | 55,04821991 | 86,08382807 |
| 26 | 26-27 | CB:87°53'17.71" | 11,4 | 55,04821607 | 86,0840348 |
| 27 | 27-28 | IOB:84°26'20.74" | 12,88 | 55,04821822 | 86,08421299 |
| 28 | 28-29 | IOB:17°38'19.86" | 35,99 | 55,04820643 | 86,08441345 |
| 29 | 29-30 | IOB:5°14'16.03" | 32,26 | 55,04789751 | 86,08457925 |
| 30 | 30-31 | IO3:4°8'9.16" | 15,67 | 55,04760868 | 86,08462094 |
| 31 | 31-32 | IOB:1°44'48.22" | 21,38 | 55,04746837 | 86,08460104 |
| 32 | 32-33 | IOB:6°28'41.04" | 40,58 | 55,04727632 | 86,08460826 |
| 33 | 33-34 | IOB:7°19'22.82" | 17,28 | 55,04691382 | 86,08467436 |
| 34 | 34-35 | IOB:11°54'5.87" | 14,44 | 55,04675969 | 86,08470639 |
| 35 | 35-36 | IO3:0°26'15.51" | 9,72 | 55,04663244 | 86,08475111 |
| 36 | 36-37 | IO3:21°51'51.74" | 9,68 | 55,04654518 | 86,08474859 |
| 37 | 37-38 | IO3:22°56'59.05" | 14,09 | 55,04646477 | 86,08469092 |
| 38 | 38-39 | IO3:80°48'43.98" | 122,08 | 55,04634866 | 86,08460323 |
| 39 | 39-40 | IO3:75°43'49.2" | 20,02 | 55,04618313 | 86,08271522 |
| 40 | 40-41 | IO3:85°7'13.41" | 15,83 | 55,0461405 | 86,08241109 |
| 41 | 41-42 | C3:84°26'51.97" | 18,35 | 55,04612956 | 86,08216406 |
| 42 | 42-43 | C3:10°18'27.9" | 22,59 | 55,04614717 | 86,08187869 |
| 43 | 43-44 | C3:17°21'1.19" | 14,91 | 55,04634718 | 86,08181849 |
| 44 | 44-45 | C3:17°53'2.22" | 16,44 | 55,04647533 | 86,0817509 |
| 45 | 45-46 | C3:26°20'20.91" | 33,69 | 55,04661627 | 86,08167411 |
| 46 | 46-47 | C3:28°18'35.2" | 45,47 | 55,04688867 | 86,08144433 |
| 47 | 47-48 | C3:23°50'6.14" | 77,96 | 55,04724989 | 86,0811125 |
| 48 | 48-49 | C3:18°39'22.27" | 36,49 | 55,04789299 | 86,08062951 |
| 49 | 49-50 | C3:15°49'24.38" | 29,86 | 55,04820442 | 86,08045162 |
| 50 | 50-51 | C3:27°52'20.27" | 19,11 | 55,04846306 | 86,08032824 |
| 51 | 51-52 | C3:34°13'11.58" | 18,6 | 55,04861549 | 86,08019077 |
| 52 | 52-1 | CB:65°22'47.39" | 516,65 | 55,04875453 | 86,08002922 |